

Design drawing

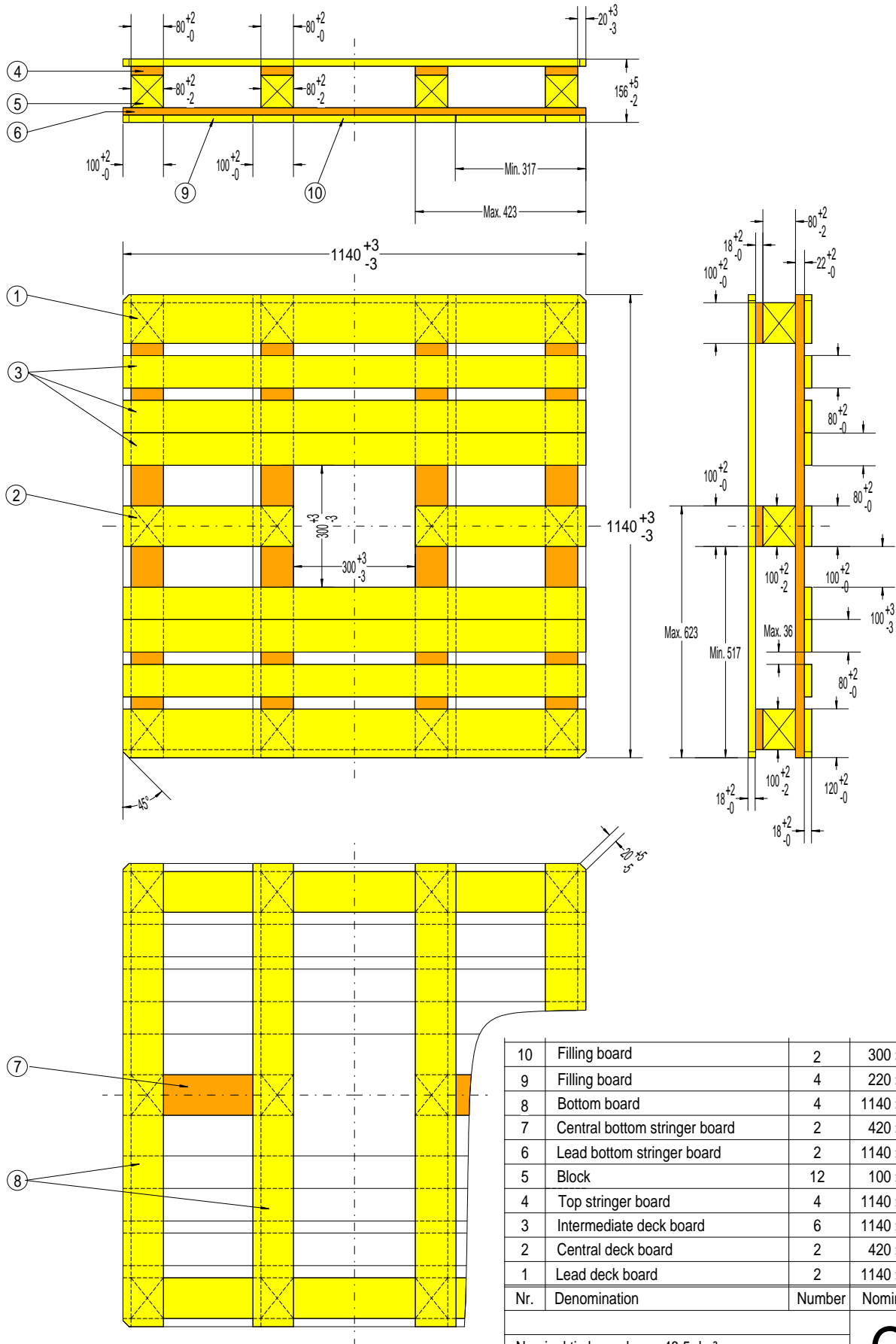

10	Filling board	2	300 x 100 x 18
9	Filling board	4	220 x 100 x 18
8	Bottom board	4	1140 x 100 x 18
7	Central bottom stringer board	2	420 x 100 x 18
6	Lead bottom stringer board	2	1140 x 100 x 18
5	Block	12	100 x 80 x 80
4	Top stringer board	4	1140 x 80 x 22
3	Intermediate deck board	6	1140 x 80 x 18
2	Central deck board	2	420 x 100 x 18
1	Lead deck board	2	1140 x 120 x 18
Nr.	Denomination	Number	Nominal dimensions

Nominal timber volume: 48,5 dm³

Unit of measurement: mm Projection

Wooden pallet 1140 x 1140 mm

CP8

April 2004

Edition: 6

Fastening pattern

Top view

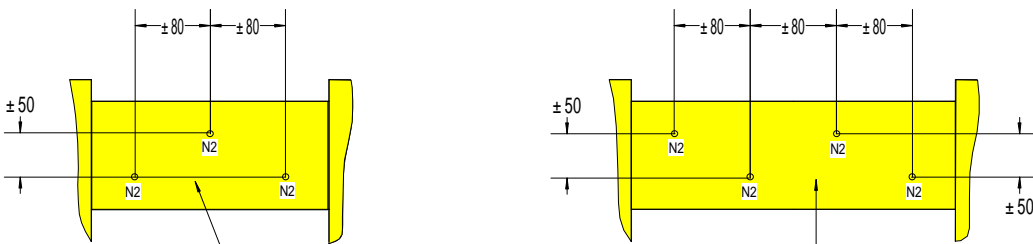
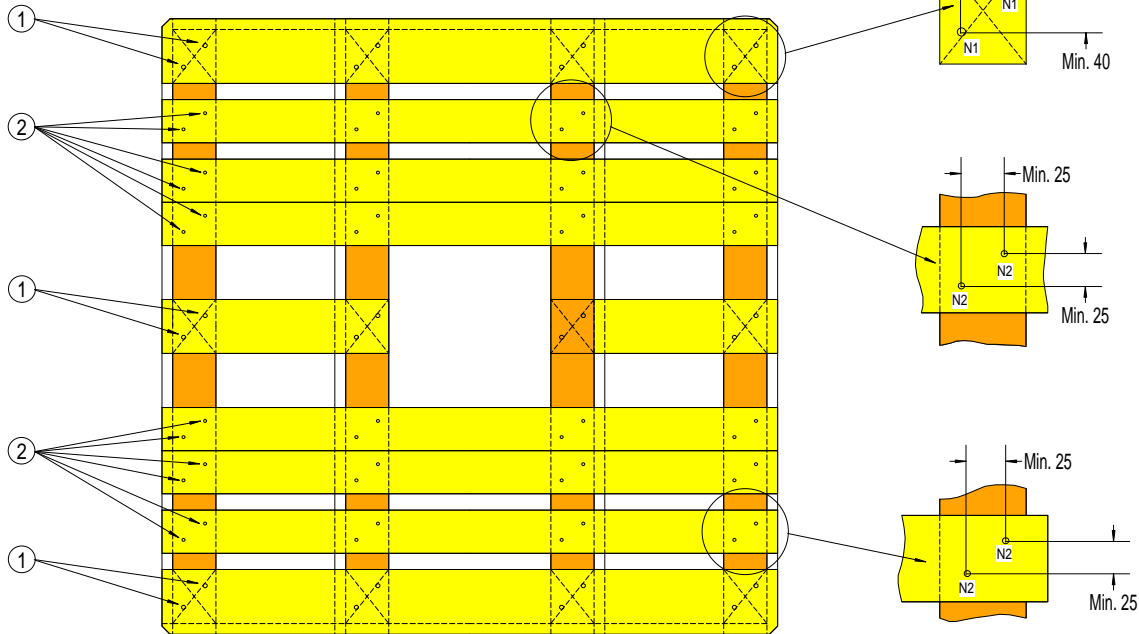

Bottom view

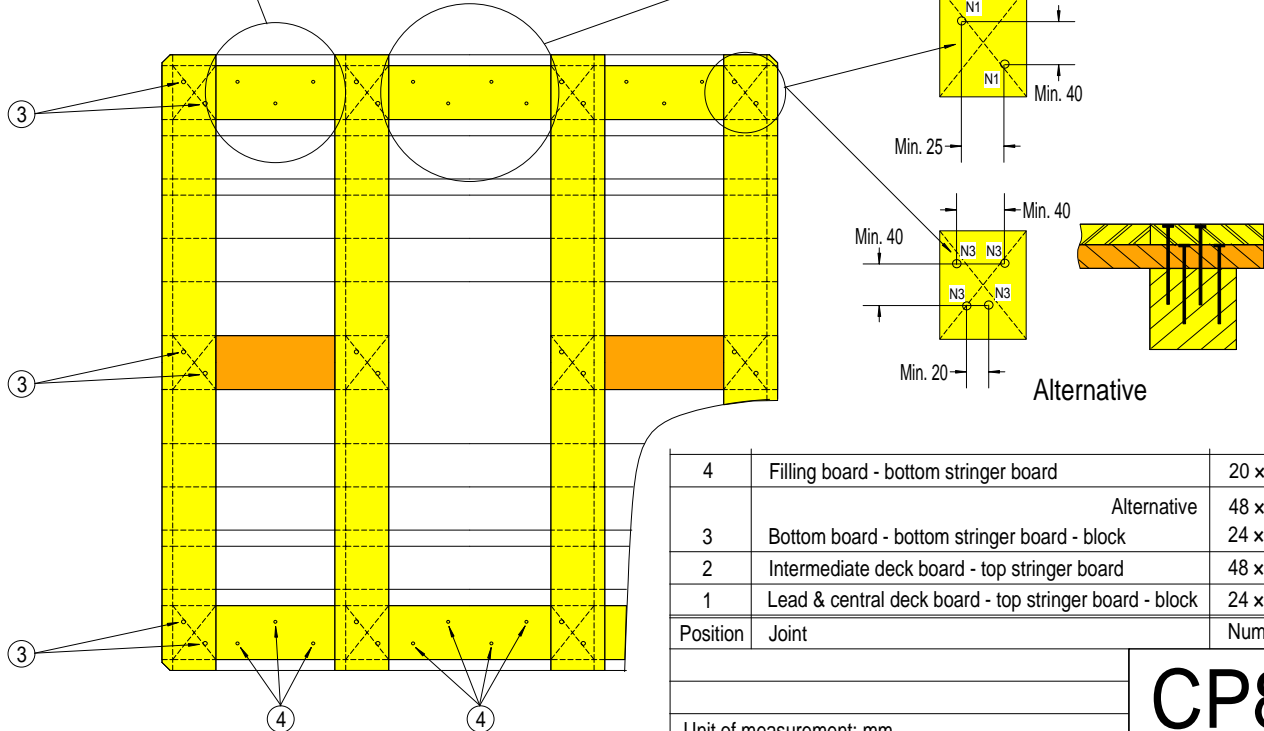

4	Filling board - bottom stringer board	20 x N2
	Alternative	48 x N3
3	Bottom board - bottom stringer board - block	24 x N1
2	Intermediate deck board - top stringer board	48 x N2
1	Lead & central deck board - top stringer board - block	24 x N1
Position	Joint	Number

Unit of measurement: mm

Wooden pallet 1140 x 1140 mm

CP8

April 2004

Edition: 6